

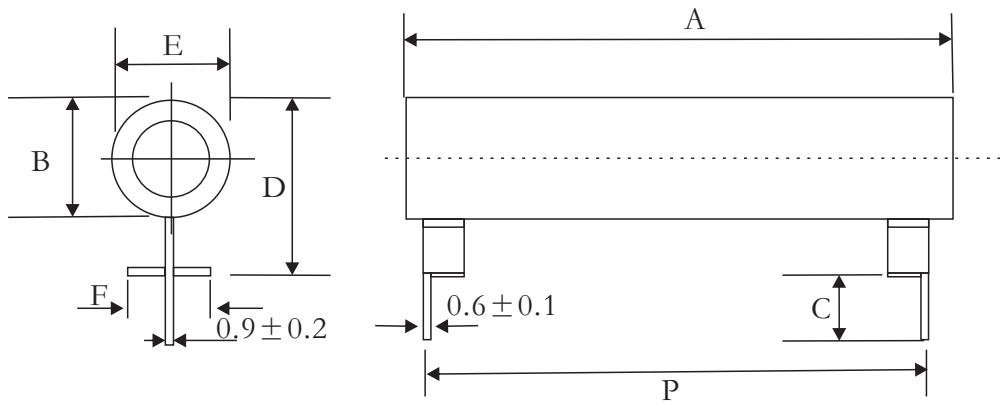

● Features

- I High temperature silicone coating
- II Eliminates lead forming to keep parts off of PC board
- III Built in standoffs provide PC board heat protection and opposing feet to avoid rocking
- IV Available in non-inductive style (special "NI") with Ayrton-Perry winding

● Dimensions



Type	Power @25°C	Resistance Ranges (Ω)		Dimensions(mm)						
		± 5%	± 10%	A ± 1.57	B ± 0.78	C ± 1.57	Dmax	E _{max}	F _{max}	P ± 0.381
KFS03	3W	1.0 ~ 6K	0.1 ~ 6K	25.40	5.08	9.14	11.43	7.41	10.16	15.24
KFS05	5W	1.0~15K	0.1~15K	28.58	5.08	9.14	11.43	7.41	10.16	22.86
KFS07	7W	1.0~17.5K	0.1~17.5K	25.40	7.94	9.14	15.24	10.41	12.7	15.24
KFS08	8W	1.0~20.5K	0.1~20.5K	28.58	7.94	9.14	15.24	10.41	12.7	22.86
KFS10	10W	1.0~29K	0.1~29K	44.45	7.94	9.14	15.24	10.41	12.7	33.02
KFS12	12W	1.0~58K	0.1~58K	53.98	7.94	9.14	15.24	10.41	12.7	43.18
KFS20	20W	1.0~60K	0.1~60K	50.80	11.11	4.82	18.41	13.49	13.49	43.18
KFS20S	20W	1.0~95K	0.1~95K	60.33	11.11	4.82	18.41	13.49	13.49	55.88

● Ordering Information

Example:

KFS	05	J	10R00	N
(1)	(2)	(3)	(4)	(5)
Series Name	Power Rating	Resistance Tolerance	Resistance	Style

(1)Type: KFS SERIES

(2)Power Rating:03=3W,05=5W,07=7W,08=8W,10=10W,12=12W,20=20W

(3)Tolerance: J= ± 5%,K= ± 10%

(4)Resistance Value:0R100=0.1Ω,0R200=0.20Ω,10R00=10Ω,10K00=10KΩ

(5) Style:N:Non-inductive style,W:Wire Wound Resistor

Reference Standards

JISC 5201-1

Applications And Ratings

Type	Power @25°C	Resistance Ranges (Ω)		Tolerance	T.C.R PPM/°C	Operating Temp.Range	Max Working Voltage (V)
		± 5%	± 10%				
KFS03	3W	1.0 ~ 6K	0.1 ~ 6K	± 5% ± 10%	> 20Ω ± 260ppm/°C < 20Ω ± 400ppm/°C	-55°C ~ +325°C	$\sqrt{P \times R}$
KFS05	5W	1.0~15K	0.1~15K				
KFS07	7W	1.0~17.5K	0.1~17.5K				
KFS08	8W	1.0~20.5K	0.1~20.5K				
KFS10	10W	1.0~29K	0.1~29K				
KFS12	12W	1.0~58K	0.1~58K				
KFS20	20W	1.0~60K	0.1~60K				
KFS20S	20W	1.0~95K	0.1~95K				

Derating Curve

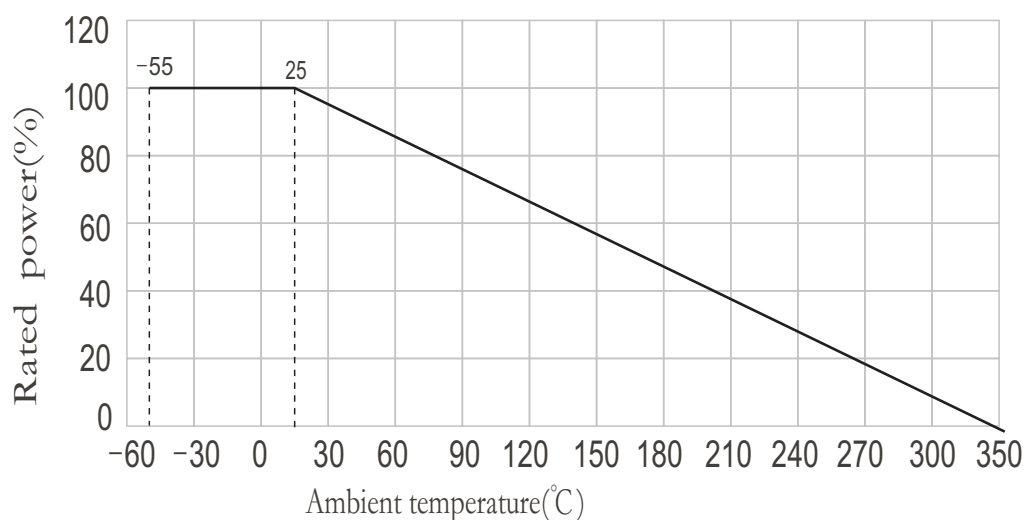

Performance

Parameter	Unit	FS Resistor Characteristics
Temperature Coefficient	ppm/°C	± 260 for 20Ω and above, ± 400 for 1Ω to 19.99Ω, special TC's available please contact factory
Short Time Overload	-	10 x rated power for 5 s
Dielectric Withstanding Voltage	Vac	1000, from terminal to mounting hardware
Maximum Working Voltage	V	$\sqrt{P \times R}$
Operating Temperature Range	°C	-55°C to +350°C